



Finish Options

Worksurfaces, drawers and doors



Light Oak



Maple



Cherry



American Walnut



Rose Walnut

VDU Veils, Perforated Panels and Kick plates



Slate



Zinc

VDU veils, perforated panels and kick plates are also available in Polished Stainless Steel (not illustrated).

Available from:

The Disability Discrimination Act 1995 – Rights of Access

The Act places responsibility on service providers and employers to make "reasonable adjustments" so as not to disadvantage those with any type of disability (e.g. restricted mobility, visual or hearing impairment etc). *There are no specific physical requirements for reception desks under the above Act and no particular furniture design or configuration can ensure compliance.*

Company procedures should ensure that visitors with disabilities arriving at a reception desk can access services whilst maintaining their independence and dignity. "Reasonable adjustments" will vary according to the circumstances, and may be very simple. For example, ensuring that a clipboard and pen are available to enable paperwork to be completed conveniently by a wheelchair user, or training staff how best to meet and guide a visitor with a visual impairment. However, should you wish to provide enhanced reception facilities specifically for wheelchair users or visitors with limited ability to stand comfortably, we will be happy to propose a custom variation of Encounter, or supplementary matching table, designed specifically to suit the size and shape of the space you have available.

Further information is available on our web site at www.sven.co.uk, from the Disability Rights Commission at www.drc-gb.org and the Government site at www.disability.gov.uk.



Encounter is designed and manufactured in the United Kingdom.

Encounter



Aesthetics combined with practicality encounter



Your reception area is where you introduce your company to the outside world. It is where you create a first impression on your visitors, and also makes an important statement to your own staff about how your company wishes to be perceived.

Whilst visual appearance is important, receptions are also extensions of your working office. They must cater effectively for the tasks to be carried out both behind the desk and in front of it. Encounter meets all these needs.

Encounter offers custom built reception desks based around a standard series of components. This enables us to provide individually tailored units at very competitive prices. We can also accommodate special requirements, including non-standard sizes, veneer or leather inlays, and custom housings for specialist electronic equipment.

Encounter can be specified in a wide range of natural veneers, from light timbers like Maple, Oak and Beech, through to the warmer mid-tones of Cherry and the richness of American Walnut – so you can ensure your reception harmonises with your interior colour scheme. We use hand-selected crown-cut veneers, stitched and laid in our own factory, giving each piece of Encounter its own unique character.

Offered in a wide choice of high quality natural veneers...

Customised to meet your precise requirements...

Based around a core of standard components...

Turrets and Veils

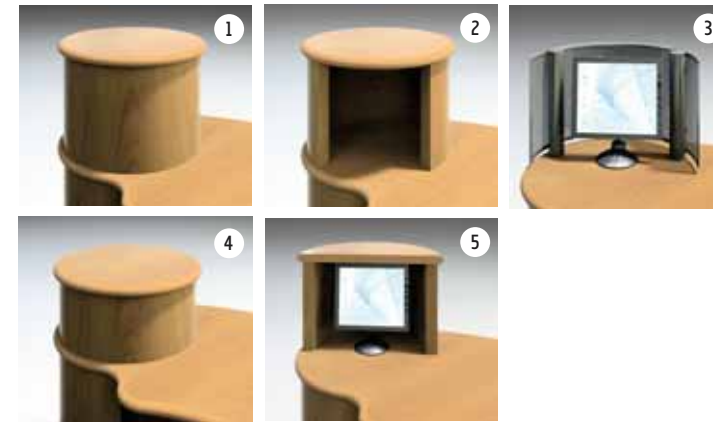

1. Full turret, high
2. Three-quarter turret, high
3. VDU Veil
4. Full turret, low
5. Half turret, low

Encounter units can optionally incorporate full, three-quarter and half enclosed turrets, in two heights. These are more than simply an interesting visual feature: they can provide a convenient standing-height surface for visitors to sign documents; conceal a security monitor – or simply provide discreet desk-level storage.

VDU Veils in perforated steel diffuse unsightly views of the rear of monitors, and can equally be used to conceal filing trays or other items without creating a solid barrier.

Counter Shelves

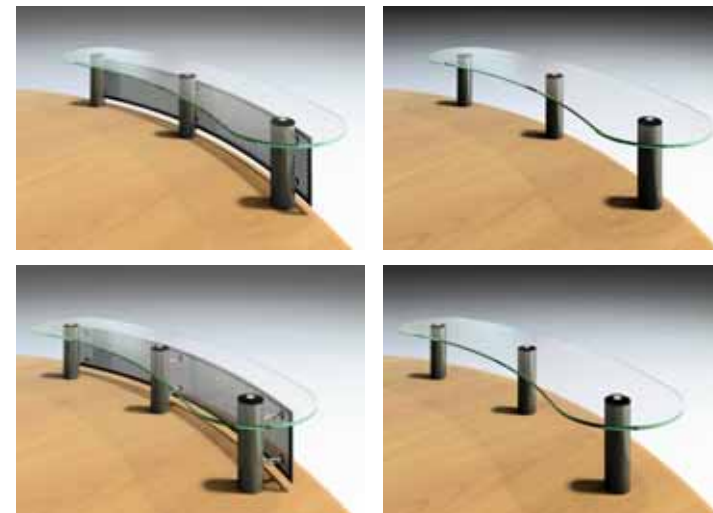

Counter shelves are available in clear glass or veneer, supported on zinc, slate or polished stainless steel columns. They may optionally be fitted with a matching perforated steel front panel. Counter shelves may be positioned flush with the edge of the desk top, or overhanging it. Shelves positioned to overhang leave more clear desk space behind them – useful if an LCD monitor is to be placed behind the shelf.

Institute of Physics

The Institute of Physics
This building was opened
by
Her Majesty The Queen
on
11th December 1996



Harmony

Encounter complements other Sven Christiansen furniture ranges – available in matching finishes. Used in combination they create a harmonious impression when your visitors move away from reception into other areas of your office.

